

PARTS ENCLOSED

- (A) Wire Nuts (3)
- (B) Anchors (4)
- (C) Mounting Plate (1)
- (D) Mounting Screws (2)
- (E) Wood Screws (4)
- (F) Side Screws (4)
- (G) Backplate (1)
- (H) Frame (1)
- (I) Bulbs (6)
- (J) Back Glass Panel (1)
- (K) Side Glass Panels (3)
- (L) Top Glass Panels (4)
- (M) Fixture Safety Cable (1)
- (N) Cable Lock Nut (1)

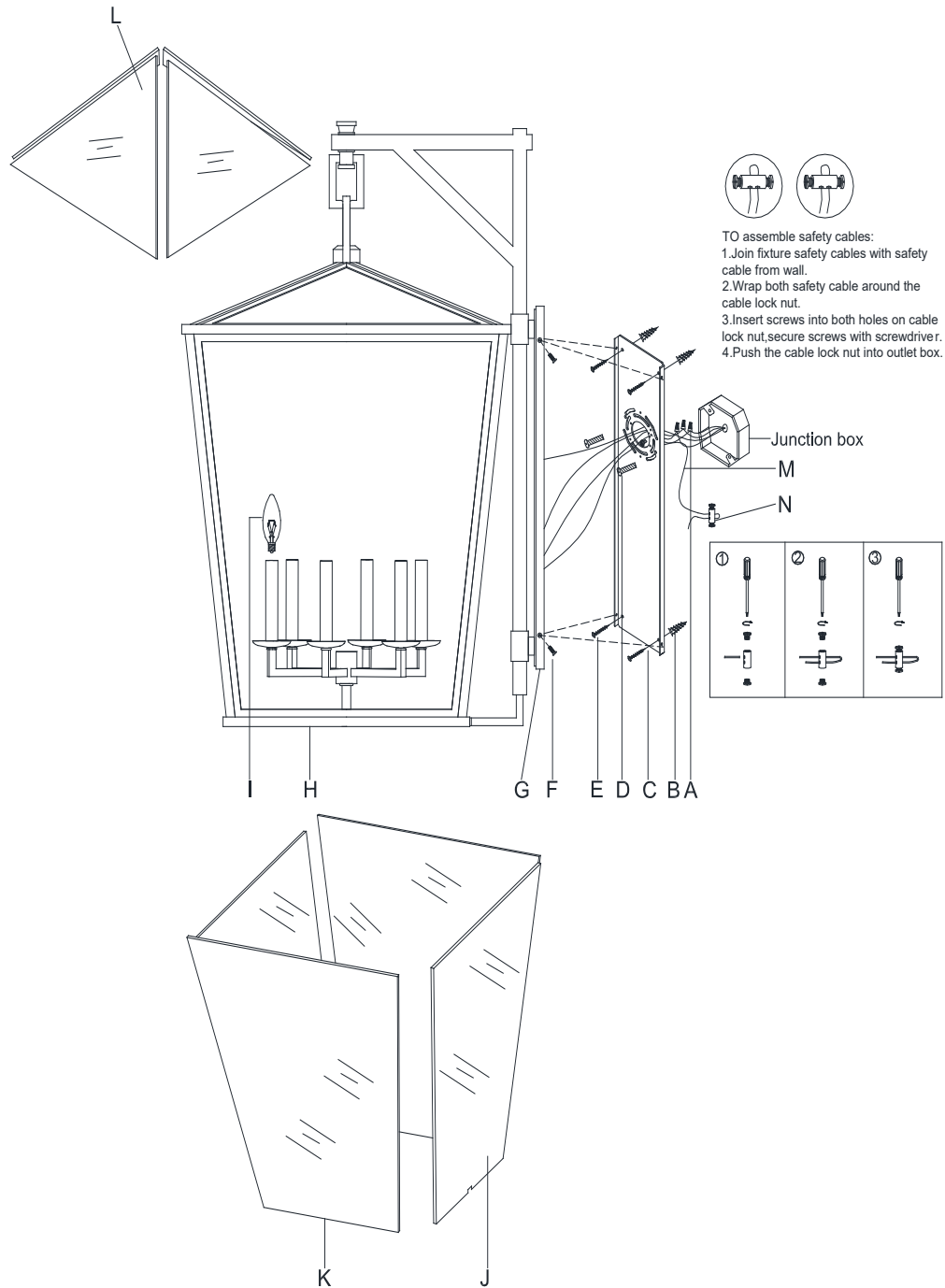

IMPORTANT SAFETY INSTRUCTIONS

INSTALLATION BY A LICENSED ELECTRICIAN IS STRONGLY RECOMMENDED.

This fixture has been rated for up to four (4) 60-Watt E12 Type B candelabra lightbulbs (not included), four (4) 13-Watt compact fluorescent lightbulbs (not included), four (4) 5-Watt LED lightbulbs (not included) or 40-Watt E12 Type B candelabra lightbulbs (included). To avoid the risk of fire, do not exceed the recommended wattage.

OUTDOOR INSTALLATION

Fixture must be mounted 4 feet from the ground. Use silicone caulk to seal the fixture where the mounting plate meets the surface to prevent water from seeping in.

WARNINGS

All wires are connected. When unpacking, be careful not to pull wires, as a bad connection may result. Do not connect electricity until your fixture is fully assembled. To reduce the risk of fire, electrical shock, or personal injury, always turn off fixture and allow it to cool prior to replacing the lightbulb. Do not touch or look directly at the bulb when fixture is illuminated. Keep flammable materials away from lit bulb.



WARNING: This product can expose you to lead, which is known to the State of California to cause cancer and birth defects or other reproductive harm. For more information, go to www.P65Warnings.ca.gov.

THIS PRODUCT IS NOT A TOY AND HAS NO PLAY VALUE.



WARNING: STRANGULATION HAZARD

Keep cord at least 3 feet away from cribs, bassinets, and toddler beds. Keep out of reach of children under 3 years of age.

ASSEMBLY & INSTALLATION

SHUT OFF THE MAIN ELECTRICAL SUPPLY FROM THE FUSE BOX OR CIRCUIT BREAKER PANEL.

1. Carefully remove all parts from the box and remove all plastic coverings.

ASSEMBLY & INSTALLATION CONT.

2. Remove Mounting Plate (C) from Backplate (G) by loosening Side Screws (F).
3. Drill 4 holes on the wall and make sure the hole distance will match to the holes on Mounting Plate (C).
4. Knock Anchors (B) into the wall holes.
5. Affix Mounting Plate (B) to the wall outlet box, then secure with Mounting Screws (D) and Wood Screws (E).
6. Join fixture Safety Cable (M) with the safety cable from the wall.
7. Wrap both safety cables around Cable Lock Nut (N).
8. Insert screws into both holes on Cable Lock Nut (N) and secure screws using a screwdriver (not provided).
9. Push Cable Lock Nut (N) into the wall outlet box.
10. Connect the fixture ground wire (bare) with the ground wire from the outlet box using a Wire Nut (A). If your house does not have a ground wire, then attach this wire to the green grounding screw inside of the outlet box. IT IS IMPERATIVE THAT THIS FIXTURE BE GROUNDED.
11. Connect the fixture neutral wire (ribbed, no markings) with the neutral wire from the outlet box using a Wire Nut (A).
12. Connect the fixture hot wire (smooth edge, markings) with the hot wire from the outlet box using Wire Nut (A). DO NOT REVERSE THE HOT AND NEUTRAL CONNECTIONS OR SAFETY WILL BE COMPROMISED.
13. Affix Backplate (G) to Mounting plate (C) and secure with Side Screws (F).
14. Insert Bulbs (I) into each of the sockets.
15. Fit Top Glass Panels (L) onto Frame (H) and secure in place by bending the metal tabs.
16. Fit Back Glass Panels (J) onto Frame (H) and secure in place by bending the metal tabs.
17. Fit Side Glass Panels (K) onto Frame (H) and secure in place by bending the metal tabs.
18. Installation is complete, turn on power at fuse or circuit breaker.

CARE INSTRUCTIONS

Do not use polishes or cleaners on the fixture. Wipe clean with a soft, dry cloth.